



PHANTOM 65

US OPTIONS PRICE LIST

EFFECTIVE FROM 1ST JANUARY 2024

Valid for yacht deliveries from 1st January to 31st December 2024

Use the links below to download the latest free Adobe Acrobat PDF Reader to suit your device



For use on PC or Mac

For use on tablet or smartphone

PHANTOM 65

OPTIONAL SPECIFICATION

LAYOUT

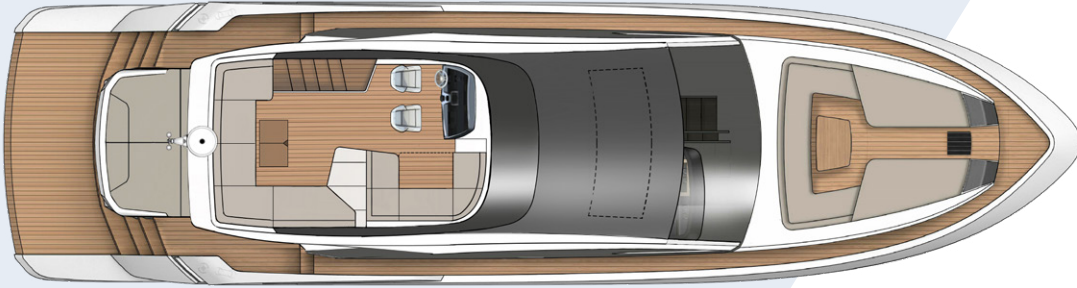

Sportbridge

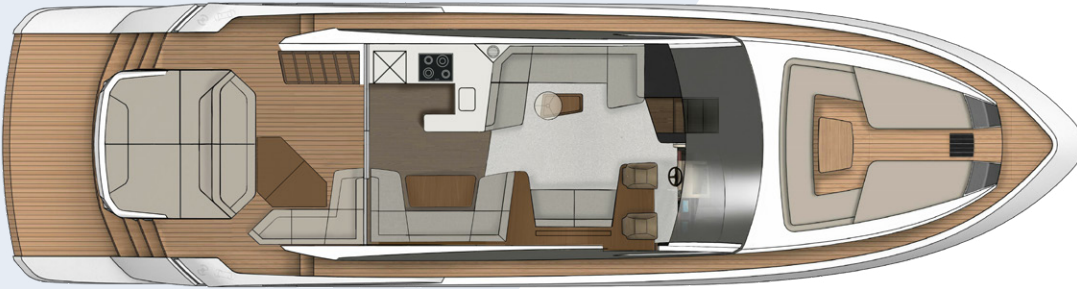

Main deck

PHANTOM 65

OPTIONAL SPECIFICATION

LAYOUT

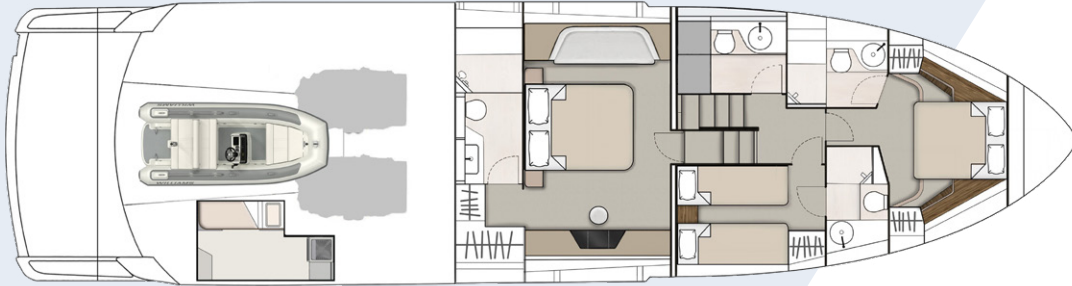

3 Cabin

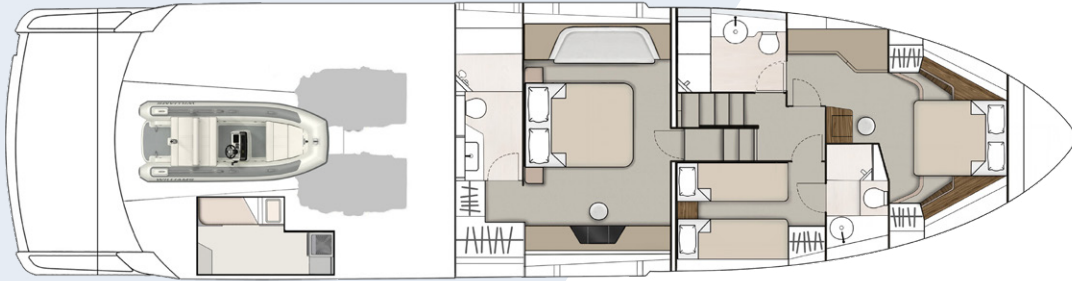

3 Cabin with extended VIP

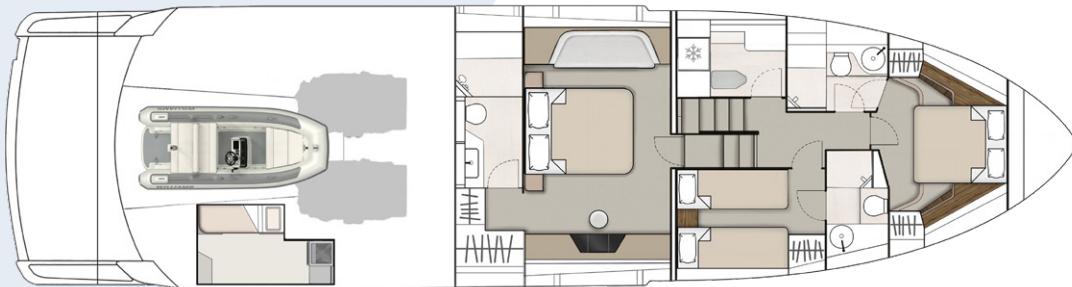

3 Cabin with utility room

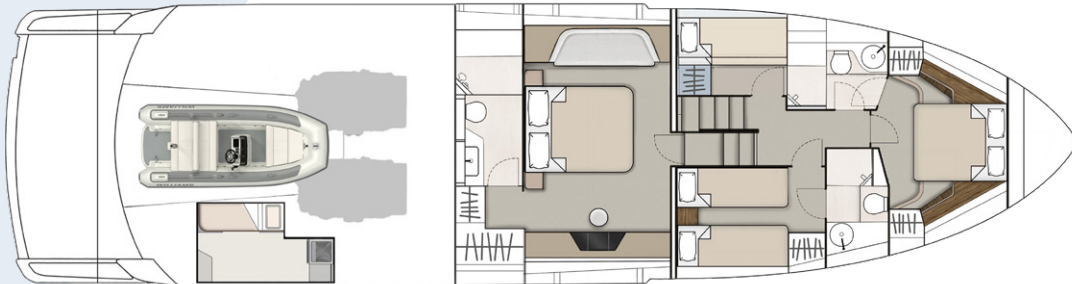

4 Cabin

PHANTOM 65

OPTIONAL SPECIFICATION

| | MSRP (\$) | Select option |
|---|---------------|---------------|
| ENGINES | | |
| Twin Caterpillar® C18-1150, 2300 hp | \$4,242,000 | |
| Twin Caterpillar® C32-1622, 3244 hp | \$4,768,000 | |
| LAYOUT | | |
| Extended forward VIP cabin OR | \$22,865 | |
| Utility room (in lieu of day head) OR | \$18,615 | |
| Fourth cabin (in lieu of day head) | \$22,865 | |
| Sideboard to salon (in lieu of starboard sofa) | \$8,245 | |
| Drawers to master cabin (in lieu of sofa) | \$8,840 | |
| Electric sliding bed conversion to starboard cabin (twin to double) | \$9,775 | |
| Crew cabin | \$32,895 | |
| EXTERIOR COLOR | | |
| White | | NCO |
| Hull band | | |
| Light Grey | Midnight Blue | Steel Blue |
| | | \$37,315 |
| Antifoul | | |
| Black | Blue | Grey |
| | White | None |
| | | NCO |
| Waterline stripe | | |
| Silver/Graphite | Silver/Navy | |
| | | NCO |
| DYNAMIC CONTROL & STABILIZATION | | |
| Bow & stern thrusters - proportional, electric OR | \$35,615 | |
| Bow & stern thrusters - hydraulic (not available with Seakeeper® stabilizer) | \$74,120 | |
| Sleipner® hydraulic vector fin stabilizer (not available with C-32 engines) OR | \$198,815 | |
| Humphree® electric fin stabilizer (not available with C-32 engines) | \$218,280 | |
| Seakeeper® 18 gyroscopic stabilizer | \$263,415 | |
| Humphree® Interceptors | | |
| COMFORT system: Auto Trim & Auto List | \$24,565 | |
| DYNAMIC PLUS system: Stabilization Roll, Co-ordinated Turn, Auto Trim & Auto List | \$43,265 | |
| TOTAL | | |

Effective from 1st January 2024.

All options to be ordered 16 weeks prior to start of build.

NCO = No Cost Option

POA = Price On Application

PHANTOM 65

OPTIONAL SPECIFICATION

| | MSRP (\$) | Select option |
|---|-----------|---------------|
| ELECTRONICS & NAVIGATION | | |
| Garmin® Automatic Identification System (AIS) | \$2,542 | |
| Garmin® cameras to engine room & cockpit | \$5,015 | |
| Second Garmin® 16" multi-function display to lower helm | \$14,365 | |
| Third Garmin® 16" multi-function display to lower helm | \$14,365 | |
| Garmin® 16" multi-function display to upper helm | \$14,365 | |
| Second Garmin® 16" multi-function display to upper helm | \$14,365 | |
| Garmin® GMR Fantom 54 open array radar | \$12,410 | |
| Garmin® Surround View camera system | \$40,715 | |
| AUDIO/VISUAL | | |
| Fusion® PLUS | \$31,875 | |
| Fusion Apollo® audio & waterproof speakers to foredeck & flybridge | | |
| Smart TV, Apollo® audio & speakers to all guest cabins | | |
| WiFi connectivity throughout | | |
| Premium | \$53,465 | |
| Integrated Sonos® audio system with flush-mounted speakers, roaming speakers, amplifiers and subwoofers | | |
| Zoned throughout the yacht and controlled via the Sonos (Apple & Android) App | | |
| Smart TVs to guest cabins | | |
| WiFi connectivity throughout | | |
| KVH6 Sat TV throughout, with secondary 'dummy' dome | \$48,025 | |
| 'Dummy' domes to radar arch (x2) | \$9,860 | |
| HEATING | | |
| Heating system to interior (for use when ambient water temperature <5°C) | \$27,115 | |
| GARAGE/TENDER | | |
| Universal-fit chocks & pad eyes to bathing platform | \$4,420 | |
| Air compressor (to crew cabin/aft lazarette) | \$2,040 | |
| Williams® 345 SportJET™ with underwater lighting | POA | |
| SEABOB® F5FS | POA | |
| FINISHING TOUCHES | | |
| Electric high/low dining/coffee table to salon | \$14,365 | |
| Digital safe | \$1,275 | |
| Toilet/bidet to en suites (excluding crew) | \$6,460 | |

TOTAL

Effective from 1st January 2024.

All options to be ordered 16 weeks prior to start of build.

NCO = No Cost Option

POA = Price On Application

PHANTOM 65

OPTIONAL SPECIFICATION

| | MSRP (\$) | Select option |
|--|-------------------------|---------------|
| DECK HARDWARE | | |
| Anchor upgrade | \$19,975 | |
| Lewmar® semi-automatic anchor system to helm with chain counter | | |
| Polished stainless 99lbs Ultra™ anchor | | |
| 80m of 12mm stainless steel chain | | |
| Stainless steel bow plate | | |
| Aft mooring capstans | \$9,265 | |
| Anchor wash | \$2,040 | |
| Side access door to lower helm | \$32,725 | |
| Side boarding gates and ladder | \$11,475 | |
| Passarelle (4.5m) | \$74,715 | |
| Glendinning® Cable Master | \$20,825 | |
| Teak to side decks & foredeck | \$42,415 | |
| Teak to sportbridge floor | \$45,815 | |
| Teak foredeck table (with cantilever pedestal for stowage) | \$10,115 | |
| Freshwater deck wash outlets | \$2,040 | |
| DOMESTIC APPLIANCES | | |
| Dishwasher to galley | \$4,165 | |
| Freshwater maker | \$31,960 | |
| Freezer to lobby | Washer/dryer to lobby | \$5,015 |
| Grey waste tank with diverter for sea discharge or deck pump-out | | \$13,515 |
| Griddle & icemaker to sportbridge bar | | \$6,715 |
| Icemaker to cockpit | Refrigerator to cockpit | \$4,420 |
| LIGHTING | | |
| Underwater lights | | |
| Dual color (blue/white) | | |
| 4 to transom | | \$15,215 |
| 2 to port and 2 to starboard sides | | \$15,215 |
| OR | | |
| RGBW | | |
| 4 to transom | | \$26,520 |
| 2 to port and 2 to starboard sides | | \$26,520 |
| Exterior mood lighting | Blue | White |
| | | |
| Interior mood lighting | | \$12,665 |

TOTAL

Effective from 1st January 2024.

All options to be ordered 16 weeks prior to start of build.

NCO = No Cost Option

POA = Price On Application

PHANTOM 65

OPTIONAL SPECIFICATION

| | | | | | MSRP (\$) | Select option |
|--|---------------|------------------|----------|-----------------|-----------|---------------|
| COVERS | | | | | | |
| Bimini (hydraulic) | | | | | | |
| Beige Chine | Linen | Navy | Charcoal | Black | \$44,965 | |
| Cockpit canopy | | | | | | |
| Beige Chine | Linen | Navy | Charcoal | Black | \$12,155 | |
| Cockpit sunshade (electric) | | | | | | |
| | | | | | \$28,475 | |
| Foredeck sky canopy | | | | | | |
| | Linen | Navy | Charcoal | Black | \$21,675 | |
| Mosquito screens to opening portholes | | | | | | |
| | | | | | \$2,720 | |
| UV heat reduction ceramic film to salon windows, patio door & windshield | | | | | | |
| | | | | | \$13,175 | |
| Blackout windshield cover | | | | | | |
| | | | | | \$5,270 | |
| EXTERIOR UPHOLSTERY | | | | | | |
| Flybridge, cockpit & foredeck (feature contrast color in Petrol) | | | | | | |
| Movida Aluminium | | Movida Macadamia | | Movida Plata | | NCO |
| TIMBER | | | | | | |
| Oak Satin (with contrast features) | | | | | | |
| | | | | | | NCO |
| Oak Gloss (with contrast features) | | | | | | |
| | | | | | \$21,420 | |
| Walnut Satin | | | | | | |
| | | | | | \$33,915 | |
| Walnut Gloss | | | | | | |
| | | | | | \$41,225 | |
| VENETIAN BLINDS | | | | | | |
| MAIN DECK | | | | | | |
| Pearl | Powder | Matte Silver | | Concrete | | NCO |
| LOWER DECK | | | | | | |
| Pearl | Powder | Matte Silver | | Concrete | | NCO |
| WORKTOPS | | | | | | |
| GALLEY | | | | | | |
| Koko | | | | | | |
| | | | | | | NCO |
| Carrara White | Concrete Haze | Chalk Venato | | Travertine Haze | \$2,380 | |
| EN SUITES | | | | | | |
| Koko | | | | | | |
| | | | | | | NCO |
| Carrara White | Chalk Venato | Travertine Haze | | | \$4,590 | |
| TOTAL | | | | | | |

Effective from 1st January 2024.

All options to be ordered 16 weeks prior to start of build.

NCO = No Cost Option

POA = Price On Application

PHANTOM 65

OPTIONAL SPECIFICATION

| | | | | MSRP (\$) | Select option |
|--|------------------|--------------------------|---------------|-----------|---------------|
| SALON SOFAS | | | | | |
| Fabric | | | | | |
| Alpaka Cloud | Alpaka Porcelain | Alpaka Husky | Alpaka Pepper | NCO | |
| | | | | \$9,095 | |
| Fabric | | | | | |
| Homespun Dove | Relax Linen | Schino Natural | Gypsum Inachi | | |
| Homespun Arctic | Relax Cloud | Schino Pumice | Nimbus | | |
| DINETTE SOFA | | | | | |
| Leather | | | | | |
| Birch | Limestone | Heron | | NCO | |
| MASTER CABIN SOFA & STOOL | | | | | |
| Fabric | | | | | |
| Alpaka Cloud | Alpaka Porcelain | Alpaka Husky | Alpaka Pepper | NCO | |
| | | | | \$3,825 | |
| Fabric | | | | | |
| Homespun Dove | Relax Linen | Schino Natural | Gypsum Inachi | | |
| Homespun Arctic | Relax Cloud | Schino Pumice | Nimbus | | |
| HEADBOARDS & BED SURROUNDS | | | | | |
| Alpaka Fleece/Pepper | | Alpaka Pepper/Anthracite | | NCO | |
| TIMBER FLOORING (TO GALLEY & DINETTE) | | | | | |
| Planked Oak | | | | | |
| White Oak | Smoked Oak | Nero Oak | | NCO | |
| EN SUITE FLOORING | | | | | |
| Random Oak® | | | | | |
| Lime White | Dove Grey | Slate Grey | Chocolate | NCO | |
| Solid Surface® | | | | | |
| Koko | | | | \$6,205 | |

TOTAL

Effective from 1st January 2024.
All options to be ordered 16 weeks prior to start of build.

NCO = No Cost Option
POA = Price On Application

PHANTOM 65

OPTIONAL SPECIFICATION

| | MSRP (\$) | Select option | | | | | | |
|--|--------------|-------------------|------------|----------|-----------|---------|---------|---------|
| CARPET (TO SALON, CABINS & LOBBY) | | | | | | | | |
| 3-CABIN | | | | | | | | |
| Wool | | | | | | | | |
| Regal Alabaster | Regal Beaver | Regal Welsh Slate | NCO | | | | | |
| Westex Silken Velvet | | | | | | | | |
| Pumice | Charm | Smoulder | Tabby Grey | \$14,365 | | | | |
| 4-CABIN | | | | | | | | |
| Wool | | | | | | | | |
| Regal Alabaster | Regal Beaver | Regal Welsh Slate | NCO | | | | | |
| Westex Silken Velvet | | | | | | | | |
| Pumice | Charm | Smoulder | Tabby Grey | \$15,215 | | | | |
| COMMISSIONING & HANDOVER | | | | | | | | |
| Commissioning and customer handover at the Fairline Commissioning Centre | | | NCO | | | | | |
| Customer handover at the vessel's home marina | | | POA | | | | | |
| Full fuel tanks, charged at the prevailing rate | | | POA | | | | | |
| OWNERS MANUAL | | | | | | | | |
| English | Finnish | French | German | Italian | Norwegian | Russian | Spanish | Swedish |

TOTAL

Effective from 1st January 2024.

All options to be ordered 16 weeks prior to start of build.

NCO = No Cost Option

POA = Price On Application

TERMS & CONDITIONS

DELIVERY

All prices are ex-works, Oundle, UK, and exclude shipping and duties.

ORDERING & PRICING CONDITIONS

This price list replaces all previous editions and is valid for orders placed with a 20% deposit and specification for delivery by 31st December 2024.

A 30% stage payment is due on installation of engines. Final boat payment is due on completion of construction at the factory.

We reserve the right to change prices without notice or liability.

All options must be specified at the time of order. No additions or alterations to orders will be accepted after the boat specification is confirmed by the factory.

Retrofit of options is not available.

IMPORTANT NOTICES

We continually seek to improve the specification and design of our boats, so alterations and upgrades to specifications take place frequently.

Whilst every effort is made to keep all sales literature up to date and accurate, it should not be regarded as an infallible statement of current specifications and does not constitute an offer for the sale of any boat.

Appointed dealers are NOT agents of Fairline Yachts Ltd or Fairline Yachts Americas LLC, and are not authorised to commit Fairline by any express or implied undertaking or representation.

PERFORMANCE FIGURES & ESTIMATES

Power figures quoted in our literature for engines is measured as crankshaft output.

Performance estimates are given in good faith but are in no way guaranteed for any boat. Dirt on the bottom of the boat, damage to propellers, engine tuning, external water and air temperatures, and the weight of crew, fuel and water carried can all adversely affect performance. For these and other reasons, we can give no performance guarantees.

Published by Fairline Yachts Americas LLC, 4000 Hollywood Boulevard, Suite 555-S, Hollywood, Florida 33021, USA
Email: info@fairline-americas.com
fairline-americas.com

© FAIRLINE YACHTS LTD 2024. ALL RIGHTS RESERVED. FAIRLINE, TARGA, PHANTOM, SQUADRON AND F-LINE ARE REGISTERED TRADEMARKS OF FAIRLINE YACHTS LTD. TOGETHER WITH ALL TEXT AND IMAGES CONTAINED IN THIS PRINTED MATERIAL, THEY ARE PROTECTED BY COPYRIGHT AND MAY NOT BE REPRODUCED IN ANY FORM WITHOUT THE EXPRESS WRITTEN PERMISSION OF THE COPYRIGHT OWNERS.

v. 1

Fairline Yachts Americas reserve the right to change pricing and specification without prior notice.

Fairline Yachts Americas Terms of Business apply. All previous pricelists are replaced.